

# WIRE ROPE USER'S MANUAL

## 1. Load & unload when transport:

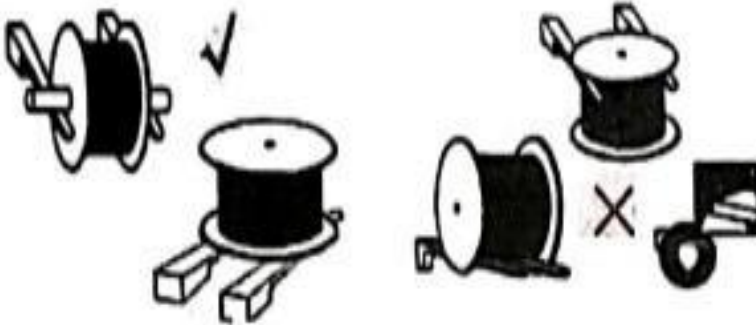

Correct way

Wrong way

To avoid rainwater infiltration and corrosion, please do attention to cover tarpaulin when railway or highway transport.(Note: please attention to moisture proof)

## 2. The maintenance for casting wire rope sling:

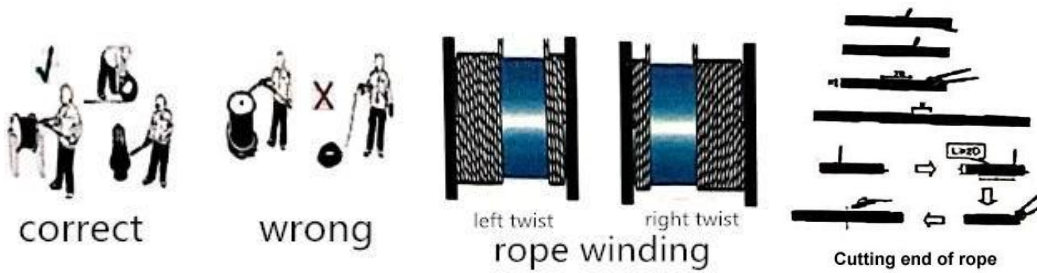

To avoid corrosion for wire rope sling, please do attention to lubricate and maintain it regularly.

**3. The correct way for releasing & rolling ropes:**

**4. The inspection of steel wire rope:**

Please inspect the wire rope regularly and record the inspection result. Inspection items include: the situation of wear degree, broken wire, corrosion, lubrication, deformation, connecting point, the wear degree of the ground roll which supports the steel wire rope, the end fastening and other anomalies.

The rope slides on the drum, pulley and ground roll. Long-time friction will result in wear and tear, so the groove forming. Under this situation, the wear of rope is speed up and deformations damage the life loss. Therefore, these components must be inspected and maintained frequently. If any deformation, they should be replaced immediately.

**5. Pulley and groove**

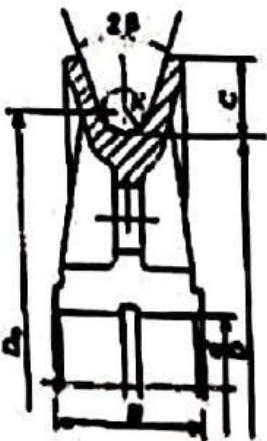
The pulley and shaft completely match or not is very important for the service life of the wire rope. The wire rope will use longer if choose proper pulley and concave-groove.



Main dimensions of the pulley as following:

$$D_{\text{min}} > 25D$$

$$R = (1.06 - 1.08)D/2$$

$$B = 35^2 - 40^2$$

C- The depth of groove, to prevent the rope jumping out (mm)

D- The dip angle diagram: roller, dip angle, pulley (mm)

Pulley geometry diagram

## 6. Dip angle

Dip angle is the dominant factors for rope winding on a smooth reel.

Dip angle is usually defined as the angle between two straight lines. One of them is from the center line of the rope wheel to the inner edge of the reel, and the other one is from the center line of the rope wheel to the shaft of the reel. (See the sketch)

Dip angle diagram

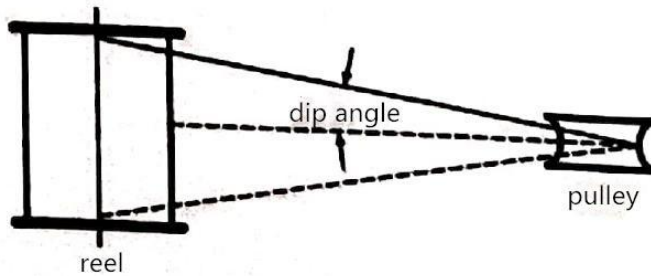

NOTE: Scrap wire rope cannot be reused; it should be disposed according to the state environmental stipulations.

[Yantai Orient Heavy Industry Technology Co., Ltd](#)

## ◆ CONTACT US:

**YANTAI ORIENT HEAVY INDUSTRY TECHNOLOGY CO., LTD**

**Add: No 16 Gangcheng East Street, High-tech Zone, Yantai City, China.**

**Tel: +86-535-6762198**

**WhatsApp: +8617561161909**

**Email: [info@heavyindustryparts.com](mailto:info@heavyindustryparts.com)**

**Website: [www.heavyindustryparts.com](http://www.heavyindustryparts.com)**

**[LinkedIn](#) [Facebook](#) [Twitter](#) [YouTube](#) : [Yantai Orient](#)**

**[Instagram](#) [TikTok](#) [Pinterest](#) [WeChat](#) : [yantaorient](#)**